

# Portable Lithium Solar Generator

## Instruction Manual

### CLEO



### Packing List

- 1 Pcs Cleo Portable Solar Generator
- 1 Pcs AC Adaptor (including AC charging cable)
- 1 Pcs Cigarette Lighter Cable (cigarette port to DC7909 connector male)
- 1 Pcs MC4 Cable (MC4 connector to DC 7909 connector male)
- 1 Pcs User Manual
- 1 Pcs Warranty Card



Cleo



AC Adaptor



Solar Charging Cable (MC4)



AC Charging Cable



User Manual

Please visit our website [www.srportables.com](http://www.srportables.com) to register your product

# Part Description

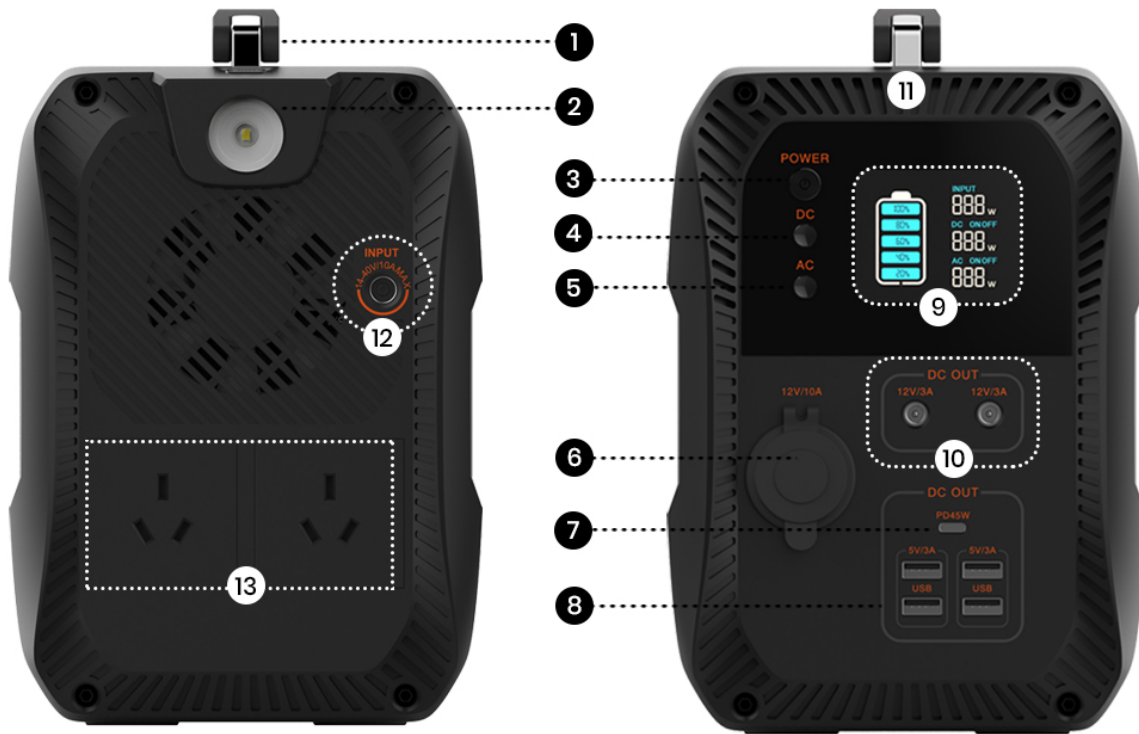

- 1. Handle Bar
- 2. LED Light
- 3. Main Power Button
- 4. DC Power Button
- 5. AC Power Button
- 6. DC12V Car ignitor output port
- 7. Type-C PD Output port
- 8. USB Output Port
- 9. LCD Screen
- 10. DC 12V 5521 Output port
- 11. LED Light Button
- 12. Charging Port
- 13. AC Output Port

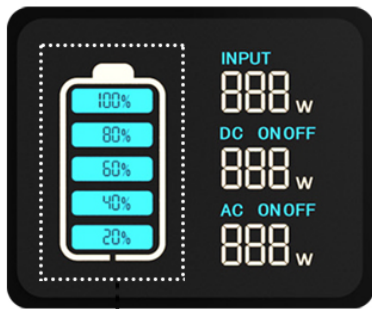

- 1. Charging Power
- 2. DC ON/OFF
- 3. DC Output Power
- 4. AC ON/OFF
- 5. AC Output Power
- 6. Battery Capacity Indicator

# Safety and Precautions

## Safety Warning

1. Please read all the safety warnings and labels before using the product.
2. Avoid exposing the product to rain or using the product in a humid environment.
3. Do not install the product near heat sources, such as electric furnaces and heaters.
4. Wipe the product clean with a dry cloth.
5. In case of fire, use dry powder fire extinguishers for this product. Do not use water fire extinguisher, which may cause electric shock.
6. Please do not alter or disassemble this product.

# Safety and Precautions

## Storage and Maintenance

1. Operating and storage environment may influence product life and the reliability of performance. Remember to:
  - (i) Place the product in a dry and well- ventilated area with mild temperature (suitable temperature: 0°C -45°C, suitable relative humidity 10% ~ 90% )
  - (ii) Place the product in a safe area where it will not fall or shake.
  - (iii) Keep the product away from corrosive and combustible material.
2. The product will turn itself off when the battery voltage is very low. If this happens, you need to charge the battery within 2-3 months.
3. If you are not going to use it for a long time, please charge it fully before storage and then charge it at least once every month. Store the product in a dry environment.

## How to Charge this Product?

### Solar Panel to Charge the Product

1. Choose a suitable solar panel (recommended DC14~40V/120W).
2. Keep the solar panel under direct sunlight and facing the sun.
3. Connect the solar panel to the product at the AC port ( Part 12 in the Part Description) using the MC4 cable.
4. Please charge the product under Operational Temperature: Charge 0°C ~ 45°C, Discharge -20°C ~ 60°C (powering appliances)
5. When the product is fully charged by the sun, it will stop charging automatically. (The charging time is different under different sunlight intensity)
6. All products can be charged and used simultaneously
7. During charging, it is normal for the product to get a little hot.
8. Please make sure the cable connections are secure and stable, or it might result in overheating and short circuits.



### AC Charger to Charge the Product

1. Always use the standard AC charger that comes with the product.
2. Insert one end of the adapter into the wall outlet and insert the other end into the input port ( Part 12 in the Part Description) of the product.
3. Please unplug the charger after charging is completed. (It takes about 5-6hrs to fully recharge the product if using a 90W AC adapter charger).
4. During charging, it is normal for the product to get a little hot.
5. Make sure that the wiring is connected properly, otherwise the contact terminals may melt or ignite at high temperatures.

### Car Charger to Charge the Product

1. Connect the product to the cigarette lighter socket ( Part 12 in the Part Description) in the car with the cigarette lighter cable provided in the package.
2. The product will be fully charged with a 24V car battery, but only partially charged with a 12V car battery.
3. Charge the product after starting the car.
4. Make sure that the wiring is connected properly, otherwise the contact terminals may melt or ignite at high temperatures.

## Turn ON/OFF the Product

1. Turn on the product: Press and hold the master power button about 2 seconds to turn on the product. The LED indicator light and the display screen will light up.
2. Turn off the product: Press and hold the master power button about 2 seconds to turn off the product. The display screen and the LED indicator light would turn off.

## AC/DC Output

1. Turn on AC/DC output: Press and hold the AC/DC power button to turn on the product. The corresponding LED indicator light would light up and the display screen would show "AC ON/DC ON".
2. Turn off AC/DC output: Press and hold the AC/DC power button to turn off the product. The LED indicator light would turn off and the display screen would show "AC OFF/ DC OFF".

**Note:** Check to make sure the product is turned on. Otherwise, you cannot turn on the AC/ DC output.

## Output

### AC Port Output

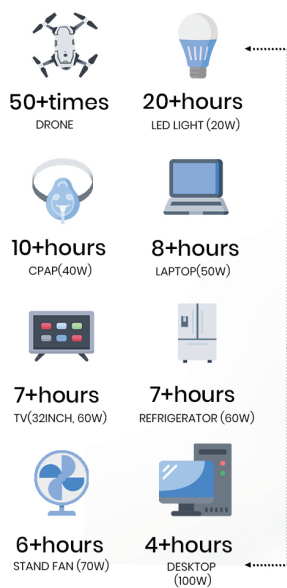

AC Output Port

### DC Port Output



## Technical Specifications

Output			
	Rated voltage	100 - 102 Vac	220 - 240 Vac
AC output	Rated power	300 W	
	Peak power	450W	
	Overload Capability	300W≤load<450W@120S; 450W≤load@1s;	
	Frequency	50/60Hz (adjustable)	
DC12V Output (cigarette lighter)	Rated voltage	12Vdc (12 14V workable)	
	Rated current	10A ①	
DC12V Output (5521)	Rated voltage	9.6 - 12.6Vdc ②	
	Rated current	3A	
USB output	QC	BC1.2, Apple, Samsung	
	Rated voltage	5V	
	Rated current	3A	
Type C Output	QC	PD2.0 (45W)	
	Rated output	5V3A, 9V3A, 12V3A, 15V3A, 20V2.25A	
LED Torch	While the power button is on, press the LED light button repeatedly. The order of LED light will be: full brightness-half brightness-SOS- Off		
Solar PV Input ③			
	Input voltage	14 - 40 Vdc	
	Input power	120W MAX	
Battery			
	Rated capacity	416Wh	
	Rated voltage	11.1Vdc	
	Battery cell type	Li- ion	
	Voltage range	9.6 - 12.6Vdc	
General			
	Protection level	IP21	
Working environment condition		Relative humidity: 10% - 90%	
		Temperature: 0°C - 45°C	
	Size	300*159*219mm	
	Net weight	6.2 kg	

## Operating Conditions

1. Operational Environment: Indoor and Outdoor (non waterproof)
2. Operational Temperature: Charge 0°C ~ 45°C, Discharge -20°C ~ 60°C (powering appliances)
3. Storage: -20°C ~ 45°C